

# Colonna

## 40X38XH127

- QCS40

Colonna in truciolare nobilitato 18 mm. Idrofugo a norme EN.

Colonna sospesa 2 ante reversibile, 2 ripiani mobili.

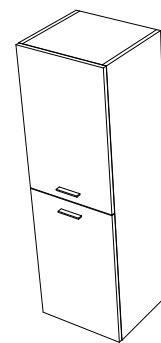

Disegni Tecnici

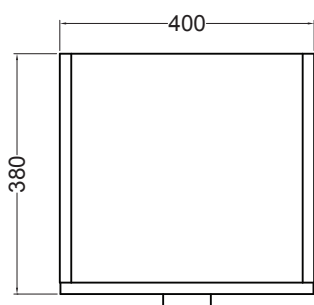

PIANTA

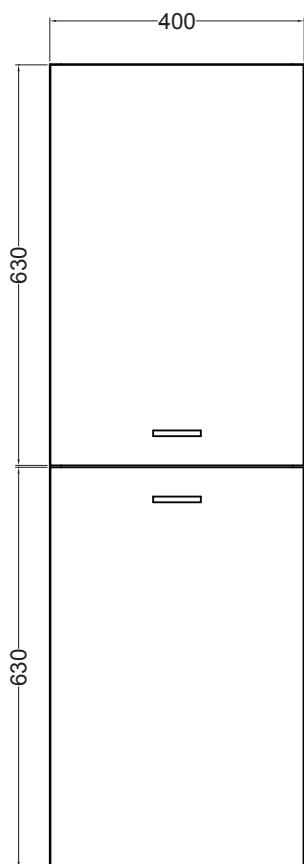

VISTA FRONTALE

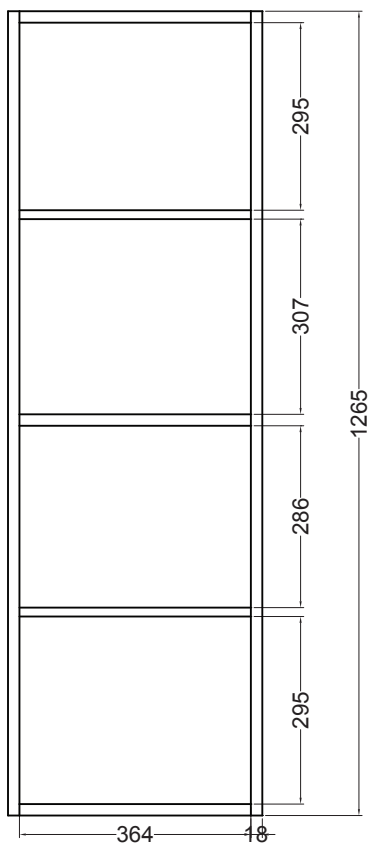

VISTA FRONTALE SENZA ANTE

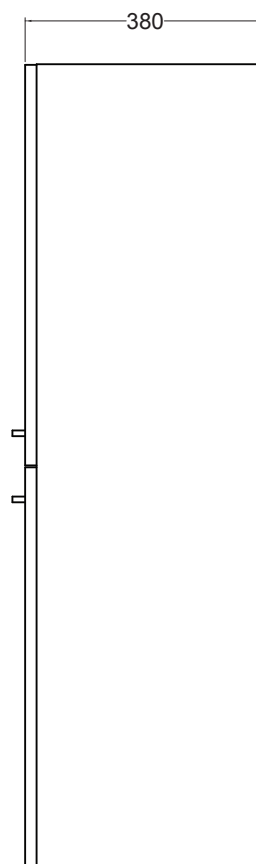

VISTA LATERALE